

Landscape Impact Assessment Report

Planning Application of Temporary Planning Application to

Shop & Services (Motor Vehicles Showroom) Use

At Lots 1689 S.C(Part), 1689 S.D(Part), 1689 S.E, 1689 S.F, 1689 S.G., 1689 S.H  
and 1689 R.P. in D.D. 109 and Adjoining Government Land, Kam Tin  
Road, Kam Tin, Yuen Long

September 2024

圖示:

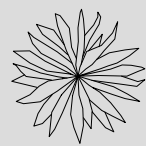

樹種: 棕櫚  
美人葵  
高度2.75M

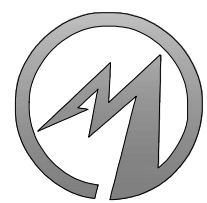
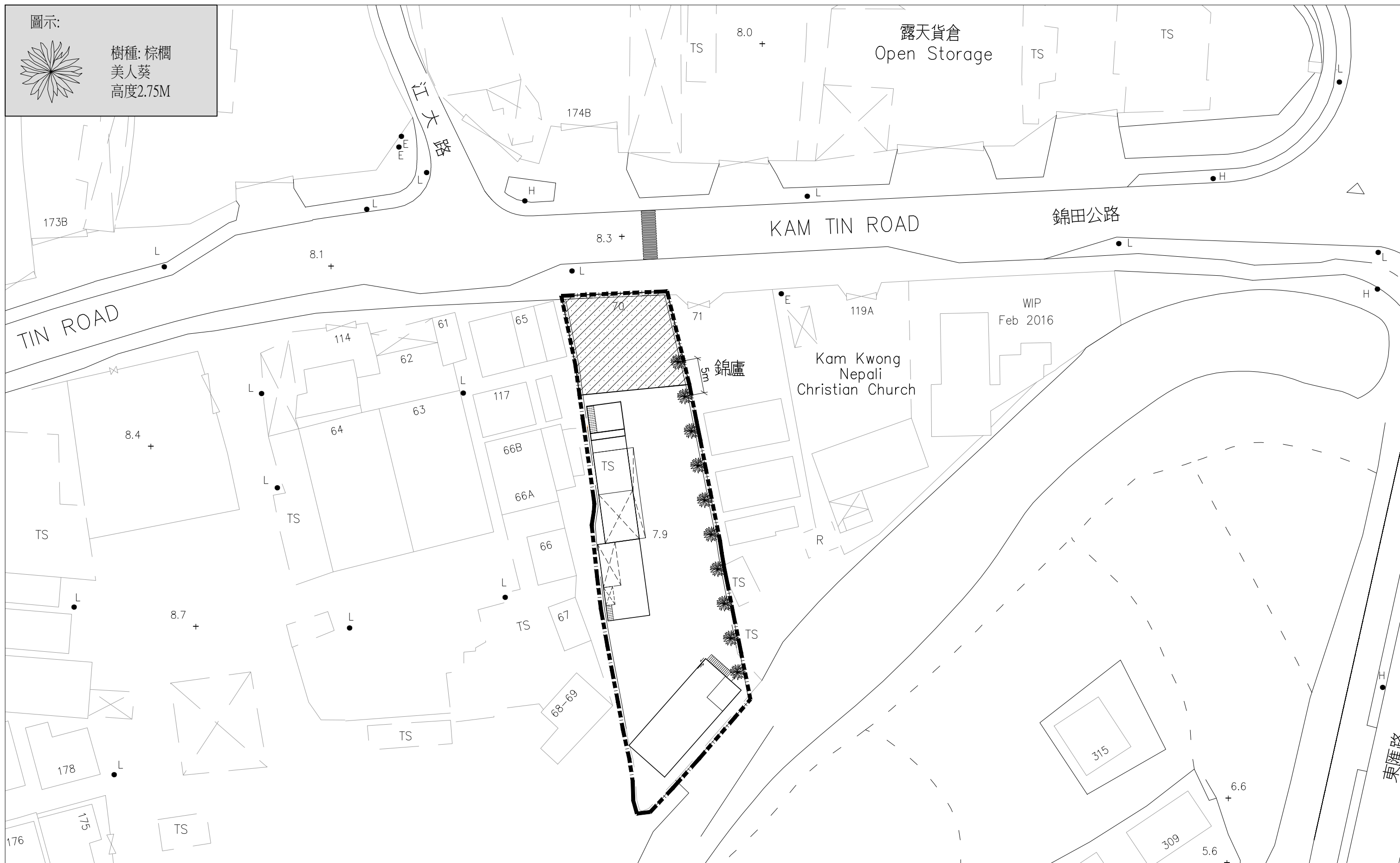

**M&D**  
**Planning and Construction**  
**Consultant Ltd.**

Tel: 2191 4088 Fax: 3105 0810  
Email: sales@moderneng.com.hk

Project  
Lots 1689 S.C. (Part), 1689 S.D. (Part),  
1689 S.E, 1689 S.F, 1689 S.G., 1689 S.H  
AND 1689 R.P. in D.D. 109 and Adjoining  
Government Land, Kam Tin Road,  
Kam Tin, Yuen Long

Application  
擬議商店及服務行業(汽車陳列室)  
之規劃許可申請為期三年

Drawing Title  
園景佈置圖

Scale  
1:500 (A3)

Drawn by  
Arthur

Checked by  
AY

Job No.  
DD109/1689

Designed by  
LW

Date  
09-SEP-2024

Drawing No.  
P-04

Notes  
Copyright Reserved nothing may be reprinted or  
utilized in any form or by any means without written  
permission from the M&D.

Revisions Description Date

種植表

植物學名稱	中文名稱	大小(毫米) 高度x樹冠闊度	間距(毫米)	數量
棕櫚	美人葵	2750Hx2000W	5000	10

1. 規劃許可的有效期內, 申請人須保持植物健康生長
2. 在規劃許可的有效期內, 申請人須更換瀕死或已枯萎的植物
3. 申請人須給予植物足夠水份

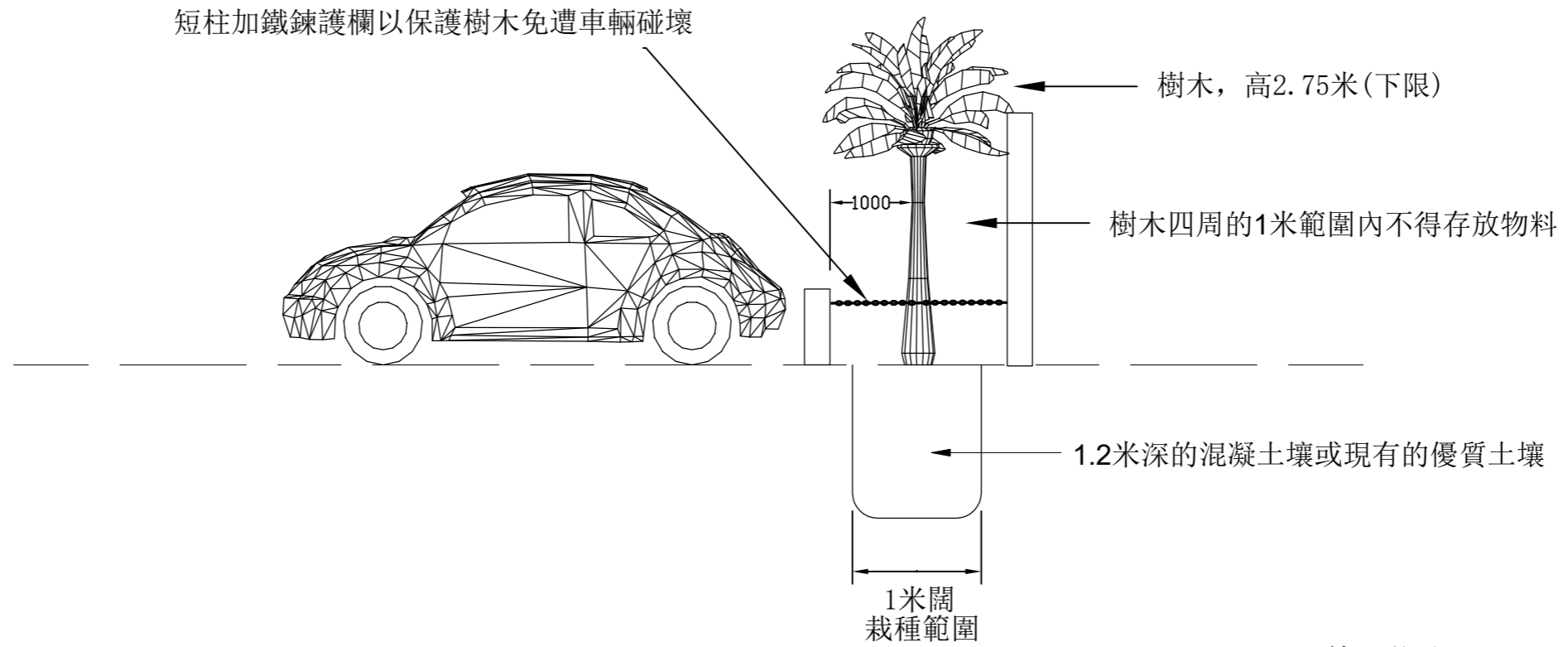

截面圖

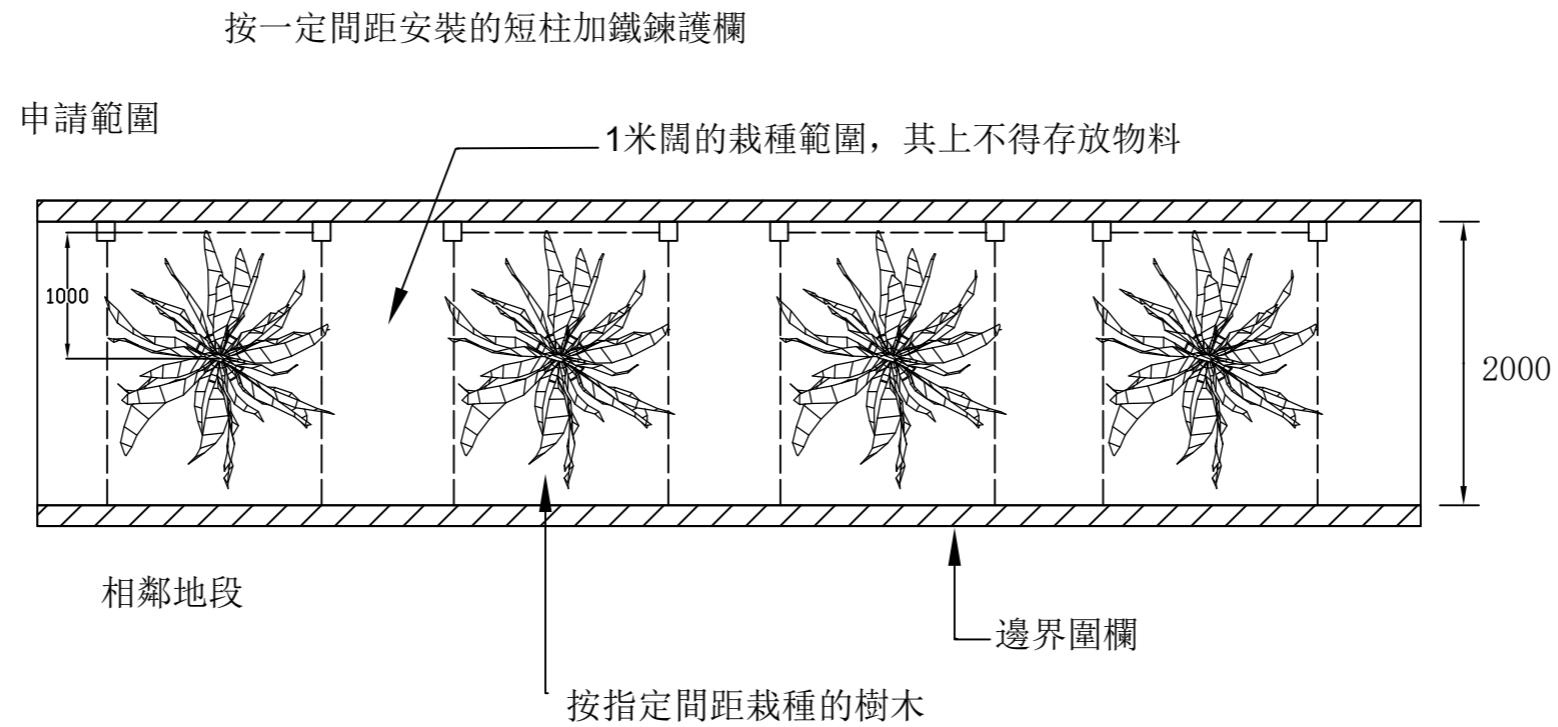

平面圖

樹木截面圖/平面圖

PROJECT:

At Section C(Part),D(Part),E,F,G,H and the Remaining Portion of Lot No.1689 in D.D. 109 And adjoining Government Land

APPLICATION:

PROPOSED TEMPORARY SHOP AND SERVICES (MOTOR VEHICLES SHOWROOM)

MARK

JOB NO.

SCALE 1:50

DATE

2024-9-9

DRAWN BY

DWG. NO.

DATE

**PLANTING SCHEDULE**

BOTANICAL NAME	CHINESE NAME	SIZE (MM) HEIGHT X SPREAD	SPACING (MM)	QUANTITY
<b>TREE</b>				
<b>SHRUB</b>				

**NOTES :**

1. THE APPLICANT SHALL MAINTAIN THE PLANTS IN GOOD CONDITION DURING THE PLANNING APPROVAL PERIOD.
2. THE APPLICANT SHALL REPLACE PLANTS WHICH ARE DYING OR DEAD DURING THE PLANNING APPROVAL PERIOD.
3. THE APPLICANT SHALL PROVIDE ADEQUATE IRRIGATION FOR THE PLANTS.

**APPLICATION SITE**

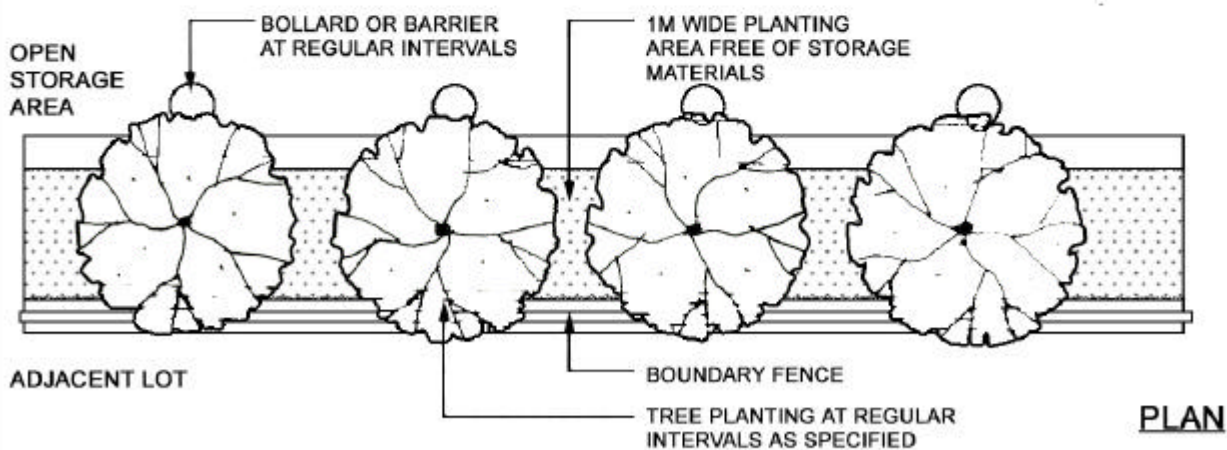
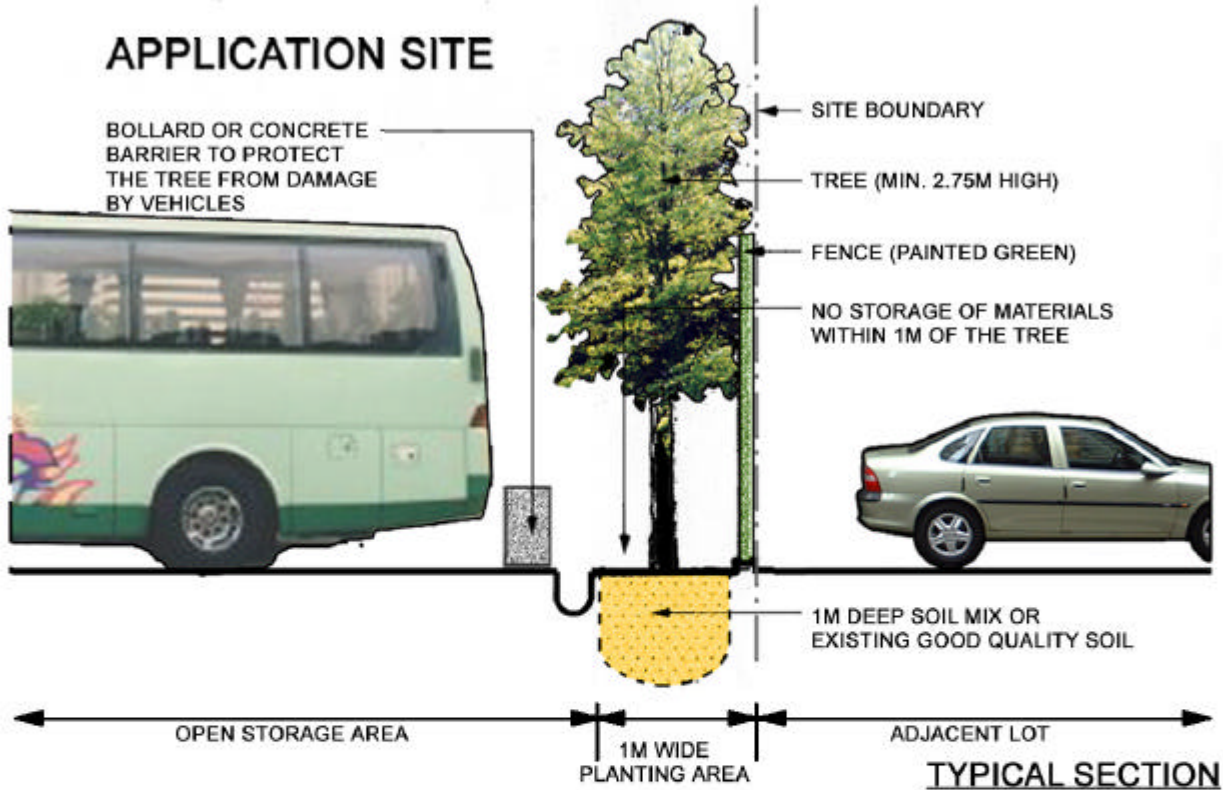

DRAWING TITLE **TYPE A**  
 BOUNDARY LANDSCAPE TREATMENT  
 FOR SITE WITHOUT PUBLIC FRONTAGE

 **PLANNING DEPARTMENT**

SCALE **1 : 50**  
 REVISION

DRAWING NO.  
**FIGURE 2**



Project : Proposed Temporary Shop & Service (Moto Vehicles Showroom)  
 Address : Lot 1689S.C., 1689S.E., 1689S.F., 1689 S.G., 1689S.H and 1689R.P in  
 D.D. 109 and Adjoining Government Land, Kam Tin, Yuen Long

SITE PHOTO FOR  
 EXISTING LANDSCAPE

REMARKS :

Date : 9/9/2024